



# SCHOOL DISTRICT No. 19 (Revelstoke) NEW ELEMENTARY SCHOOL / SCHOOL CONSOLIDATION

Information Bulletin #3– March 27<sup>th</sup>, 2006

## ELEMENTARY SCHOOL FACILITY CONSOLIDATION

The Board of School Trustees approved closure of Big Eddy Elementary School for summer 2002 as part of a plan to close two schools. At that time, both Mountain View and Mount Begbie Elementary Schools were identified as the potential second school to close. Since neither Mountain View nor Mount Begbie Elementary Schools are adequate to house the combined enrolment without significant renovations, the Board has received Ministry approval to proceed with a plan to consolidate the two central schools.

## SCHOOL SITE REQUIREMENTS

The school will be built for 300 students which, at 25 students per classroom, will consist of 12 classrooms. In addition, one Kindergarten facility will be built which will accommodate up to 40 students. Within a school of 300 students, the Ministry provides for a special education facility, a library with a computer lab, a gymnasium, admin space and multipurpose space. The approximate size of the facility would be 3,650 square metres.

In addition, the school site will provide adequate parking to accommodate staff and visitors, a bus lane for drop off, a 60' x 100' soccer field and a primary play area.

## FEASIBILITY STUDY OPTIONS

Subsequent to our first public consultation meeting and considering our initial submission to the Ministry, this Feasibility Study will now be exploring the following options:

- Option A: To renovate/enlarge Mount Begbie Elementary School, closing Mountain View Elementary School. This option requires the acquisition of additional land. This option also may require relocation of some students during the construction phase.



Important Notes - It is important to note that no work has been done in respect to the additional land required to utilize the Mount Begbie site for a larger school facility. This is a rendering only to demonstrate the size of site necessary to accommodate a consolidated school. As this option is reviewed, a detailed assessment will be undertaken of the actual availability of any additional land.

- Option B. i. To renovate/enlarge Mountain View Elementary School, closing Mount Begbie Elementary School. This option requires the acquisition of additional land and the relocation of all students during the construction phase.



Important Notes - This option retains the existing heritage building on the Mountain View site and contemplates a tear down and addition on the remaining site. It is important to note that no work has been done in respect to the additional land required to utilize the Mountain View site for a larger school facility. This is a rendering only to demonstrate the size of the site necessary to accommodate a consolidated school. As this option is reviewed, a detailed assessment will be undertaken of the actual availability of any additional land.

- ii. To build a new school at the Mountain View Elementary site, closing Mount Begbie Elementary School and demolishing the entire existing MVE facility. This option does not require relocation of students but offers limited playfield access during construction.



Important Notes – This option contemplates building a new school on the current playfield at Mountain View with a demolition of the existing facility. It is important to note that no work has been done in respect to the additional land required to utilize the Mountain View site for a larger school facility. This is a rendering only to demonstrate the size of the site necessary to accommodate a consolidated school. As this option is reviewed a detailed assessment will be undertaken of the actual availability of any additional land.

Option C: To build a new school on the 10<sup>th</sup> Street site, closing both Mountain View Elementary and Mount Begbie Elementary Schools.

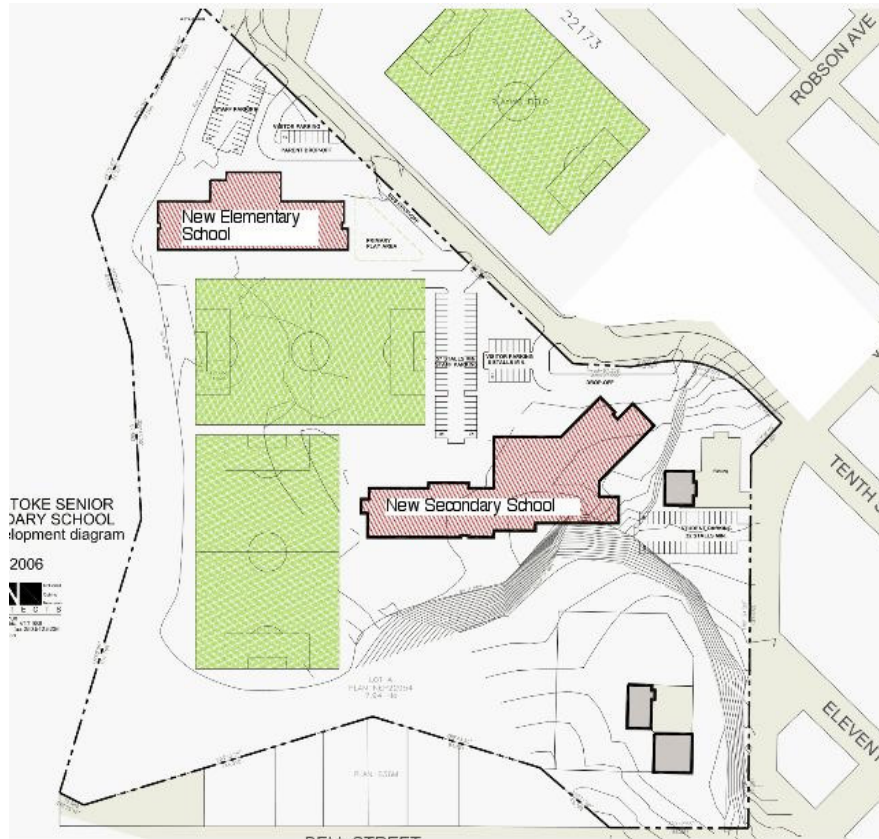

Important Notes – This option contemplates building a new school on the current district owned property along 10<sup>th</sup> Street. This is a rendering only to demonstrate the size of the 10<sup>th</sup> Street property and the ability for it to accommodate two schools with two separate playfields. No decision has been reached on this site with respect to staff or visitor parking or the actual footprint of the school. As this option is reviewed a detailed assessment will be made of the issues related to traffic, safety and the co-location of elementary students with secondary students.

#### Questions / Concerns

The Principals of Mount Begbie Elementary and Mountain View Elementary will be collecting questions and concerns which we will be presented to the steering committee. Please direct your comments to:

Shan Jorgenson-Adam, Principal MBE  
Bob Cooper, Principal MVE  
Barbara Ross, Secretary-Treasurer  
Steering Committee

[sjorgenson-adam@sd19.bc.ca](mailto:sjorgenson-adam@sd19.bc.ca)  
[bcooper@sd19.bc.ca](mailto:bcooper@sd19.bc.ca)  
[bross@sd19.bc.ca](mailto:bross@sd19.bc.ca)  
[eep@sd19.bc.ca](mailto:eep@sd19.bc.ca)

837-4056  
837-3320  
837-2101